



TECHNINE

SMB TECHNOLOGY USER GROUP

TECHNINE

SMB TECHNOLOGY USER GROUP

Best of Ignite

14 November 2018



- 18H00: Welcome
- 18H30: What's new in Windows 10 RS5 (1809) by Erik Moreau
- 19H00: Known Folder Move by Bart Bultinck
- 19H30: Break
- 19H45: Best of Ignite by Thomas Collier
- 20H15: Windows Virtual Desktop by Micha Wets
- 20H45: Networking and questions
- 21H30: End

- Who is Technine?
- Belgian SMB User Group
- Coreteam:
 - Bart Bultinck
 - Koen Verelst
 - Erik Moreau
 - Thomas Collier

Target: 4 sessions / year

- Who am I?
 - Erik Moreau
 - Technical Supervisor @ Aurelium
 - 5 Year MVP - Windows for Devices & IT
 - Windows Insider since day 1
 - Twitter @ErikMoreau

- Yes it's re-released last night 😊

Release Date:	November 13, 2018
Version:	Windows 10, version 1809

Windows 10, version 1809 Re-Released

On November 13, 2018, we will begin the re-release of the Windows 10 October Update (version 1809), Windows Server 2019, and Windows Server, version 1809. We encourage you to wait until the feature update is offered to your device automatically.

Note for Commercial Customers: November 13 marks the revised start of the servicing timeline for [the Semi-Annual Channel \("Targeted"\) release](#) for Windows 10, version 1809, Windows Server 2019, and Windows Server, version 1809. Beginning with this release, all future feature updates of Windows 10 Enterprise and Education editions that release around September will have a 30-month servicing timeline.

New support Lifecycle for Education & Enterprise

As of [September 6, 2018](#), we have evolved our servicing timeline for customers who need more time to test and deploy Windows 10 Enterprise and Education feature updates. To that end, feature updates will be serviced with monthly quality updates as follows:

Edition	March* feature updates	September* feature updates
Windows 10 Enterprise Windows 10 Education	Serviced for 18 months from release date	Serviced for 30 months from release date
Windows 10 Pro Windows 10 Pro for Workstation Windows 10 Home	Serviced for 18 months from release date, however based on your setting, the latest feature update may be automatically installed on your device upon availability.	Serviced for 18 months from release date, however based on your setting, the latest feature update may be automatically installed on your device upon availability.

* Feature updates will be released twice annual with a target of March and September.

<https://support.microsoft.com/en-us/help/4462896/updates-to-servicing-and-support-for-windows-10>

- Dark Mode

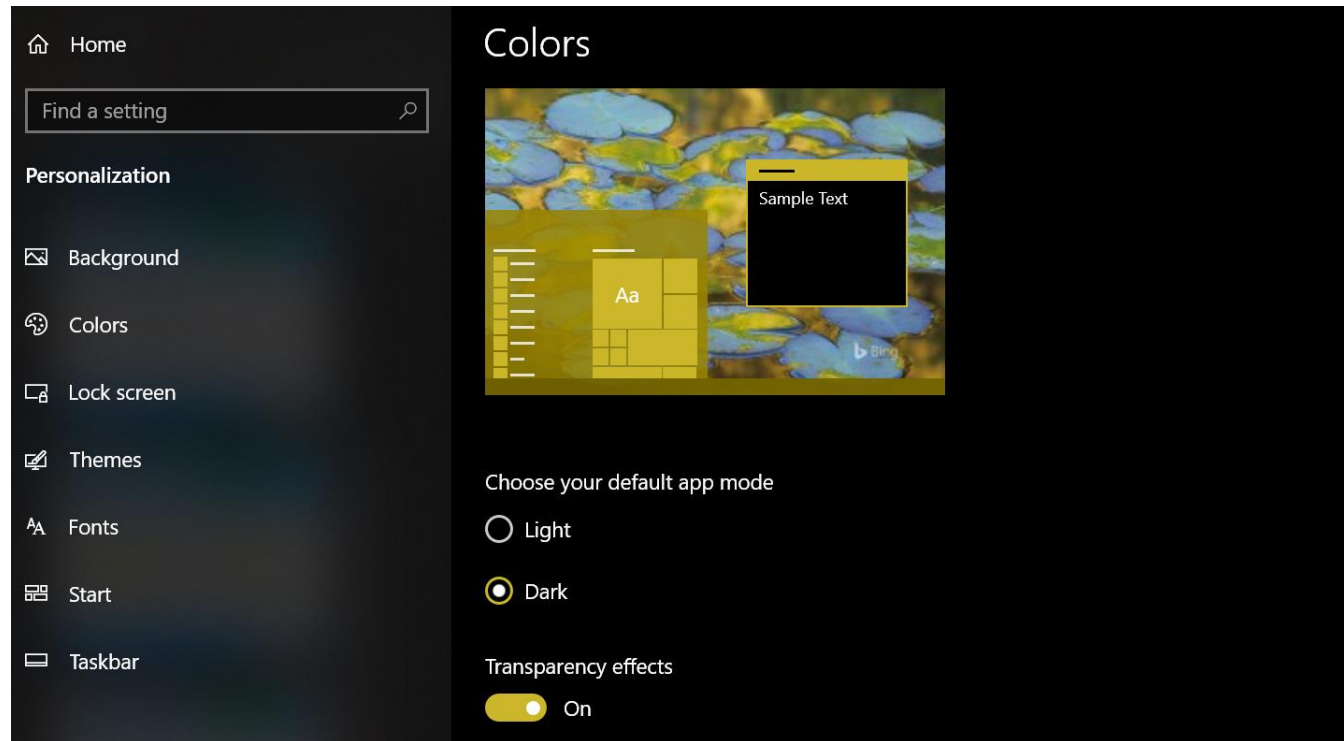

- Cloud Clipboard

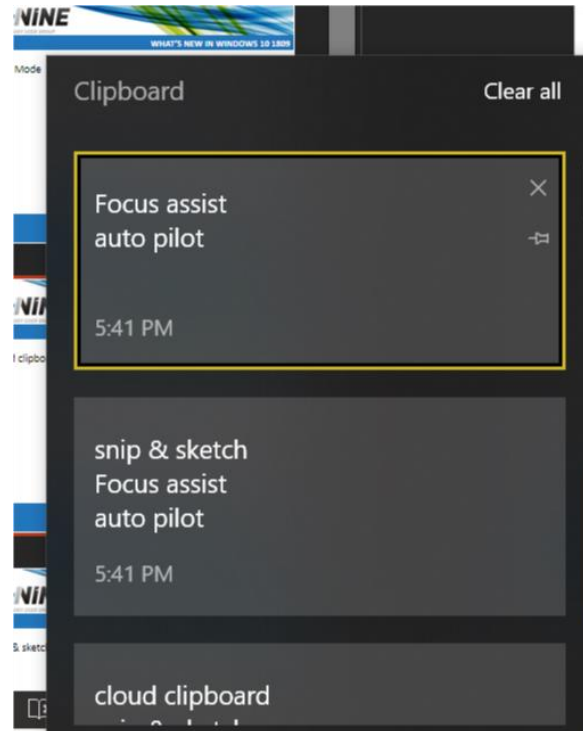

- Snip & Sketch
 - Windows + Shift + S

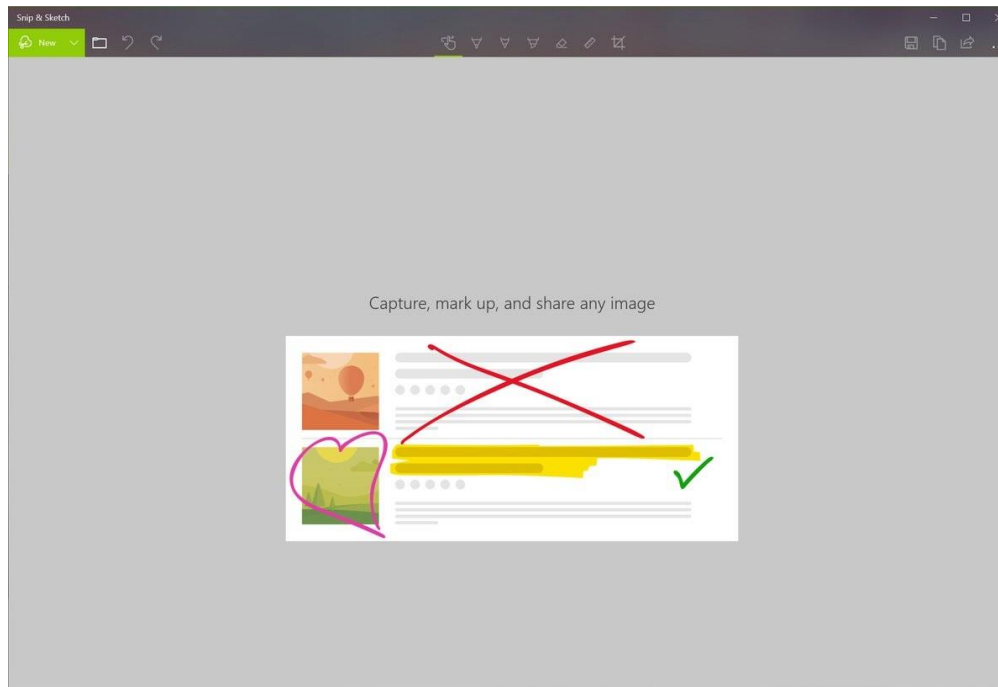

- Focus assist
 - Automatically block out notifications

- Windows Autopilot
 - Configure Windows OOBE with minimal user input
 - Currently for Azure AD Joined devices
 - On prem AD is coming & in preview with 19H1

